

## Bluetooth® Access Controller

**PR-B1124-PQ** Proximity Card Reader

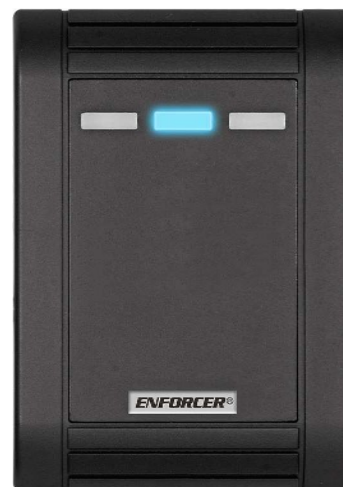

Streamlined, fully app-based setup using integrated Bluetooth® wireless technology. No codes to remember with an intuitive app designed for easy, visual programming as well as convenience and security for the user and administrator. All data is secured on the device without the risks inherent in an internet connection.



### Features

- **No Codes to Remember** – Intuitive, visual app-based programming and management, 1,000 users, device options, etc.
- **More Than Access** – Can control doors, gates, lighting, machinery, etc.
- **No Internet Exposure** – All data secured locally on device
- **Multiple User Types** – Permanent, scheduled, temporary, # of times
- **Output Modes** – Timed relock, continually unlocked or locked, toggle
- **User Customization** – Individually customizable output mode and time
- **Hold Open** – Hold door open with code or app (customizable)
- **Secure, Integrated Bluetooth** – Passcode protected, AES 128 encryption
- **Unlimited Devices** – Access/manage unlimited devices with one app
- **Easy Backup/Restore** – For off-device storage / restoration / replication
- **Wrong-Code Lockout and Tamper Alarm Output** – Customizable
- **Multilingual App Interface** – Currently supports English, Spanish, Portuguese, French, German, Russian, Vietnamese, and Chinese (Traditional or Simplified)

App-Based Setup

No Internet Exposure

1,000 Users

Audit Trail

### SL Access™ App



### App-Based Management and Control

<p><b>On-Device Security</b> AES 128 Encryption Settings, passcodes kept on device, set by the Administrator</p>	<p><b>Administrator Settings</b> Set all device parameters, manage users, view audit trail, backup/restore</p>	<p><b>User Management</b> Add, view, import/export, customize individual settings, scheduling, output settings</p>	<p><b>Audit Trail</b> View most recent 1,000 events, searchable by user and type, and download for archive</p>	<p><b>Unlock with App</b> Users can unlock the door with the app, as well as with the proximity card</p>

**SECO-LARM® U.S.A., Inc.**

16842 Millikan Avenue, Irvine, CA 92606

Phone: (949) 261-2999 | (800) 662-0800 Fax: (949) 261-7326

Website: www.seco-larm.com Email: sales@seco-larm.com



Copyright © 2025 SECO-LARM U.S.A., Inc. All rights reserved.

All trademarks are the property of SECO-LARM U.S.A., Inc. or their respective owners. The SECO-LARM policy is one of continual development. For that reason, SECO-LARM reserves the right to change prices and specifications without notice. SECO-LARM is not responsible for misprints.

**SECO-LARM® ENFORCER® CRIMEBUSTER® CBA® SLI®**

PL\_PR-B1124-PQ\_250207.docx

**Specifications**

<b>Access modes</b>	App / proximity card	
<b>Users</b>	1,000 users / 1 administrator	
<b>Operating voltage</b>	9~25 VDC	
<b>Current draw</b>	<b>Standby</b>	55mA@12VDC, 30mA@24VDC
	<b>Active (max.)</b>	100mA@12VDC, 50mA@24VDC
<b>Outputs</b>	<b>Form C</b>	2.0A@30VDC
	<b>Tamper alarm</b>	100mA@30VDC (solid state N.C.)
<b>Output modes</b>	Timed relock (1~1,800s), continually locked, continually unlocked, toggle	
<b>Inputs</b>	<b>Egress</b>	N.O. Ground
	<b>Door sensor</b>	N.C. Ground

<b>Tamper sensor</b>	Vibration detector
<b>Electrical protection</b>	Short circuit, electrostatic discharge, reverse polarity, relay contact protection
<b>Bluetooth version</b>	Bluetooth Low Energy (BLE) 4.2
<b>Proximity frequency</b>	EM 125kHz
<b>IP Rating</b>	IP65 Weatherproof
<b>Operating humidity</b>	0-95%, non-condensing
<b>Operating temperature</b>	-4°~122° F (-20°~50° C)
<b>Material</b>	ABS Plastic
<b>Dimensions</b>	3 1/8"x4 1/2"x1 1/16" (80x114x18 mm)
<b>Weight</b>	6.3-oz (180g)

**Two Ways to Unlock or Trigger a Device**

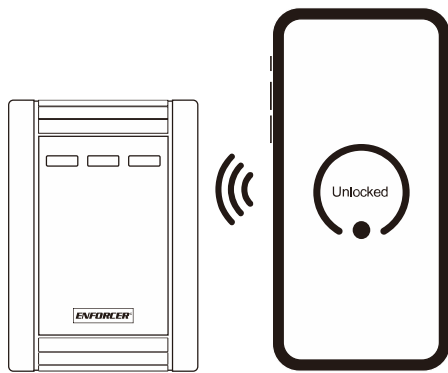

Unlock with the app

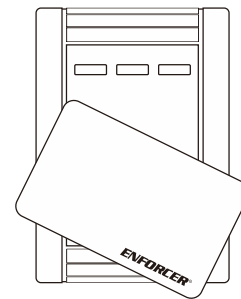

Unlock with a proximity card

**Dimensions**

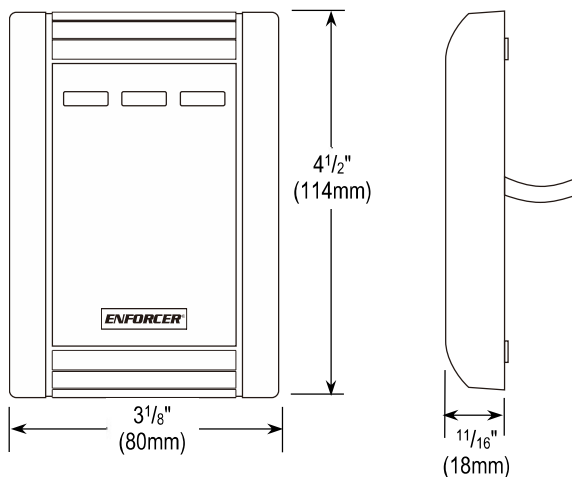

**Download the SL Access™ App**



iOS 11.0 and higher



Android 5.0 and higher

The Bluetooth® word mark and logos are registered trademarks owned by Bluetooth SIG, Inc. and any use of such marks by SECO-LARM is under license. Other trademarks and trade names are those of their respective owners.