

Junction box for mini bullet cameras

DWC-B7JUNCW



WHAT'S IN THE BOX

Waterproof O-Ring		4	Mounting Template		1
Screws and Plastic Anchors		4	Quick Setup Guide		1
RJ45 Installation Tool		1	Grommet		1
Wall Mount Mounting Screws		4			

NOTE: Download all your support materials and tools in one place.

1. Go to: <http://www.digital-watchdog.com/resources>
2. Search your product by entering the part number in the **'Search by Product'** search bar. Results for applicable part numbers will populate automatically based on the part number you enter.
3. Click **'Search'**. All supported materials, including manuals and quick start guide (QSGs) will appear in the results.



INSTALLATION

1 Separate the mounting plate from the junction base by loosening the four (4) screws. Remove the rubber stickers covering the cabling holes at the base of the junction box.

2 Using the mounting template or the junction box itself, mark and drill the necessary holes on the mounting surface.

3 Pass an RJ45 cable into the junction box base:

Option A (Recommended):

- Remove the grommet plug from the junction box.
- Pass the network cable through the grommet at the base of the camera.
- Once the cable is through, add the RJ45 connector to the network cable.

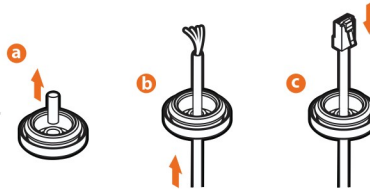

Option B:

- Attach the included RJ45 installation tool to the network cable.
- Remove the grommet plug from the junction box.
- Pass the network cable through the grommet. Pay attention to the direction of the grommet connection.

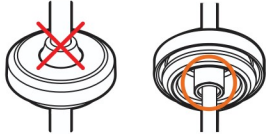
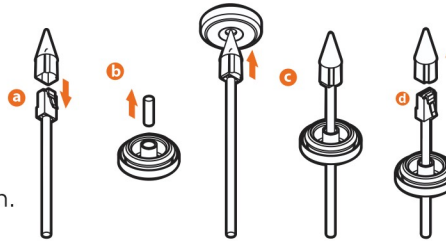

d. Remove the installation tool.

NOTE: Bending the cable may cause water leakage.

NOTE: Use the cable with a diameter of $\varnothing 0.19'' - \varnothing 0.31''$ ($\varnothing 5.0 - \varnothing 8.0\text{mm}$).

4 Secure the junction box to the mounting surface using the screws and anchors that were included with the junction box.

5 Connect the camera to the mounting plate using the included camera mounting screws. Align the camera's mounting holes with the #2 holes in the junction box. Use the camera mounting screws for holes #1 and #2.

6 Make all necessary cable connections to the camera and arrange the cables in the junction box base. For IP cameras, use the waterproof cap and gasket with the network cable to reduce the risk of water leaks. See the camera's QSG for more information.

7 Connect the mounting plate to the junction box's base using the included screws (from INSTALLATION Step 1).

8 Adjust the camera's lens position and angle using the camera's tilting arm. Lock the arm into place by securing the tilting screws at the base of the arm.

