



CS95-8

Round Recessed Stackable Enclosures For 8" Loudspeakers



CS95-8

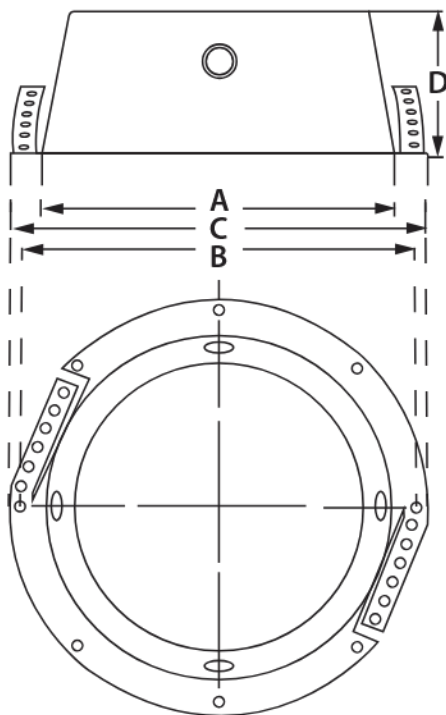

Application

Ideal for contractors with limited storage facilities, this conically shaped enclosure nests to achieve reduced inventory space requirements and transportation costs. Furnished with four combination conduit knockouts $\frac{1}{2}$ " - $\frac{3}{4}$ " (13mm-19mm), four J-clips and two flexible perforated mounting straps. One-piece CRS construction, undercoated, patch-jute lined, and finished in epoxy.

General Description

The CS95-8 enclosure is perfect for use with the Atlas Sound SD72W, SD72WV. Note: Enclosure is not designed to mount other loudspeaker packages with pre-mounted high performance transformers (HT-87, HT-167, HT-327).

Specifications

CS95-8

A	9 $\frac{3}{4}$ " (249mm)
B	11 $\frac{1}{4}$ " (286mm)
C	11 $\frac{3}{4}$ " (298mm)
D	4 $\frac{1}{4}$ " (108mm)

Mounts to Baffle Models 51-8, 60-8(W), 61-8W, 62-8, 63-8, 67-8(W), G22-8, M222(W), P900, VP60-R

Safety Listed UL1480 & UL2043

Architect and Engineer Specifications

The metal protective enclosure shall be Atlas Sound Model CS95-8 or approved equal. The enclosure shall have four 8-32 J-Clips installed in the mounting flange. The enclosures shall have 4 combination knockouts $\frac{1}{2}$ " - $\frac{3}{4}$ " (13mm -19mm) spaced 90° apart and shall be of one piece construction. Interior of enclosure shall be undercoated to prevent mechanical and acoustical resonances. Enclosure shall be finished in textured epoxy. The enclosure shall mount Atlas Sound Model _____ baffle or approved equal.

Other Suggested Mounting Accessories:

- Model 81-8R Tile Bridge: For suspended 2'x 2' or 2'x 4' ceiling applications.
- Model P78-8 Mounting Ring: To mark the enclosure location in new construction drywall (hard-deck) applications (16" stud spacing only).
- Model P77-8 Mounting Ring: For retrofit applications in drywall (hard-deck) surfaces.

NOTE: The CS95-8 Series enclosure will mount speakers with most Atlas Sound premounted line transformers. The HT-87, HT-167, and HT-327 transformer however, will not fit the enclosure when premounted to the speaker. Please consult appropriate speaker/transformer specification sheet for dimensions.

©2016 Atlas Sound L.P. All rights reserved. Atlas Sound and Strategy Series are trademarks of Atlas Sound L.P. All other trademarks are the property of their respective owners. ATS001383 RevD 6/16