

WayPoint562

Outdoor 56VDC Power Supply/Charger



Altronix WayPoint562 provides 120W for NetWay Spectrum switches with 1Gb SFP ports. It converts 115VAC, 60Hz or 230VAC, 50Hz input into a 56VDC at 2.2A of continuous supply current (see specifications). It also features a built-in charger for sealed lead acid or gel type batteries. Lightweight molded fiberglass reinforced polyester enclosure is NEMA 4/4X, IP66-11 Rated for outdoor use. It features lockable stainless steel latches and integral flanges to simplify wall or pole mounting.



WayPoint562

Specifications

Input

Voltage 115VAC, 60Hz, 2.5A or 230VAC, 50Hz, 1.3A

Outputs

Voltage 56VDC/120W output
 Current 2.2A continuous supply current
 Other Short circuit and thermal overload protection
 Filtered and regulated

Battery Charging

Type Sealed lead acid or gel type
 Failover Upon AC loss, instantaneous
 Batteries are sold separately
 Separate ventilated enclosure is required

Indicators (LED)

Input Input voltage is present
 DC Output Powered

Agency Listings

CE European Conformity

Physical and Environmental

Dimensions (H x W x D)

Enclosure: 13.31" x 11.31" x 5.59" (338.1mm x 287.3mm x 142mm)
 Shipping: 20.25" x 12.5" x 7.25" (514.4mm x 317.5mm x 184.2mm)
 NEMA 4/4X, IP66-11 Rated enclosure for outdoor use

Weight (approx.)

Product: 8.5 lb. (3.9 kg)
 Shipping: 9.7 lb. (4.4 kg)

Temperature

Operating:
 60W: -40°C to 75°C (-40°F to 167°F)
 75W: -40°C to 70°C (-40°F to 158°F)
 100W: -40°C to 55°C (-40°F to 131°F),
 120W: -40°C to 45°C (-40°F to 113°F)
 Storage: -40°C to 70°C (-40°C to 158°F)

Relative Humidity 85% +/- 5%

BTU/Hr. (approx.): 72 BTU/Hr.

Lifetime Warranty

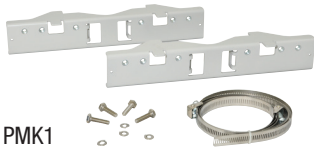
Accessories (order separately)

PMK1

PMK1 - Pole Mount Kit

PMK1 pole mount kit is designed to simplify installation of outdoor units. It accommodates 2" - 8" (diameter) poles.

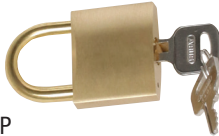

Lock1WP

LOCK1WP - Pad Lock for Altronix Outdoor Enclosures

Altronix Lock1WP is a pad lock to secure the latches on Altronix outdoor enclosures. Includes a single pad lock and key.



WG1

WG1 - NEMA Rated Wire Gland Inlet

Altronix WG1 facilitates wiring for all Altronix outdoor enclosures.

Lifetime Warranty

Dimensions and Drawing

Dimensions (H x W x D approximate)

13.31" x 11.31" x 5.59" (338.1mm x 287.3mm x 142mm)

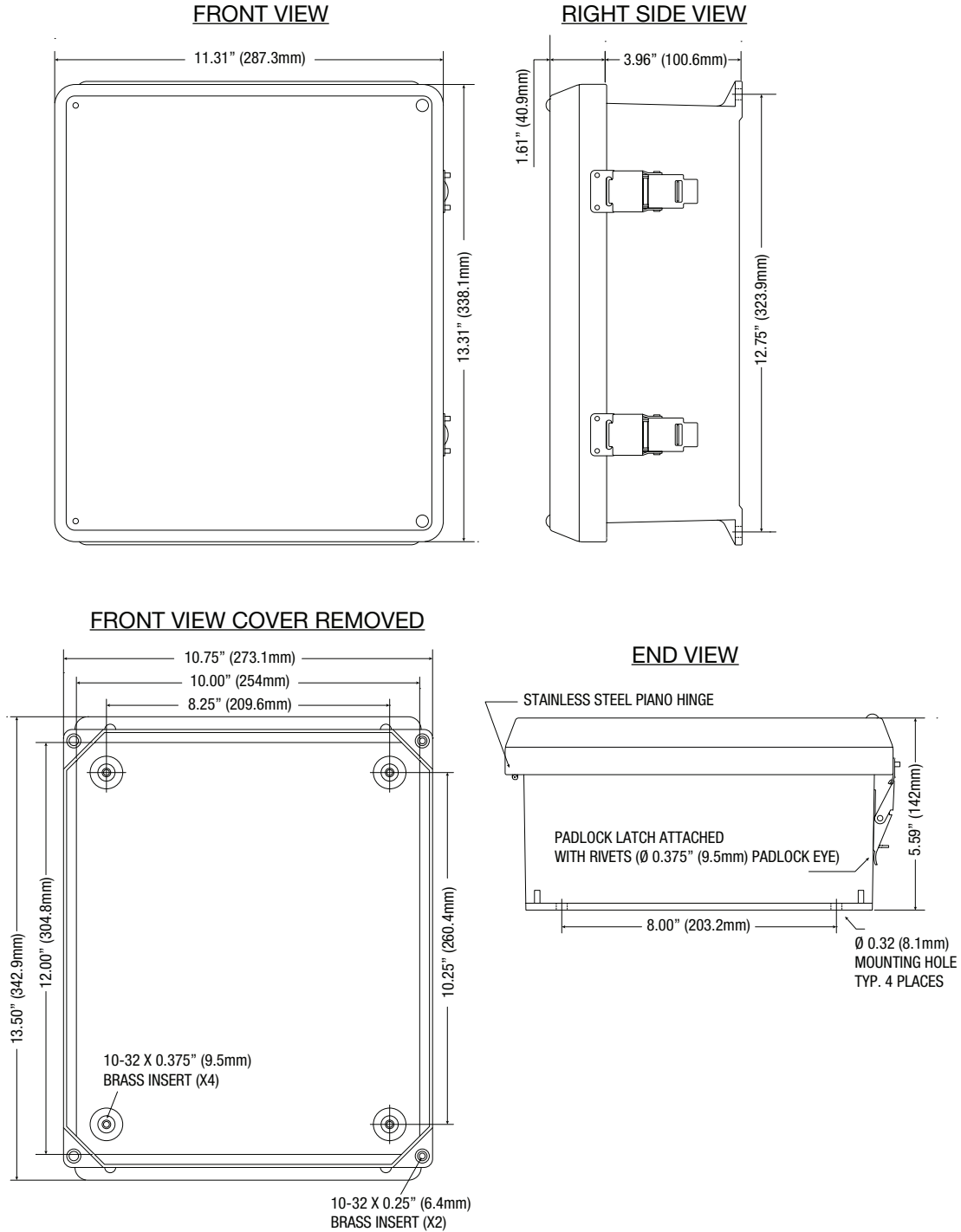

Lifetime Warranty