

NetWay1DWP

Outdoor Single Port 60W Midspan Injector



Altronix NetWay1DWP outdoor single port midspan injector provides 60W, PoE+ (30W), and PoE (15W). The unit is ideal for use with outdoor IP cameras and PTZs, WiMAX modems and WLAN access points. NetWay1DWP features a lightweight NEMA 4/4X IP66-11 rated enclosure that can be wall or pole mounted. The unit operates at 115VAC or 230VAC input. Model NetWay1DWP features enclosure with three (3) 5/8" wiring inlets and includes NEMA rated wire glands.



NetWay1DWP

Key Features

- IEEE 802.3af (15W), IEEE 802.3at (30W), and 60W compliant
- Universal 115VAC or 230VAC power input
- Power provided using all 4 pairs on structured cable
- 10/100/1000Mbps, half/full duplex, auto negotiation
- Port provides up to 60W max
- Power status LEDs
- Auto detection and protection of legacy non-PoE cameras/devices
- Extends Network link distance in an industrial environment
- Lightweight molded fiberglass reinforced polyester enclosure is corrosion resistant, non-conductive and does not contain halogens
- UL Listed in the U.S. and Canada
- CE European Conformity
- Lifetime Warranty

Typical Application

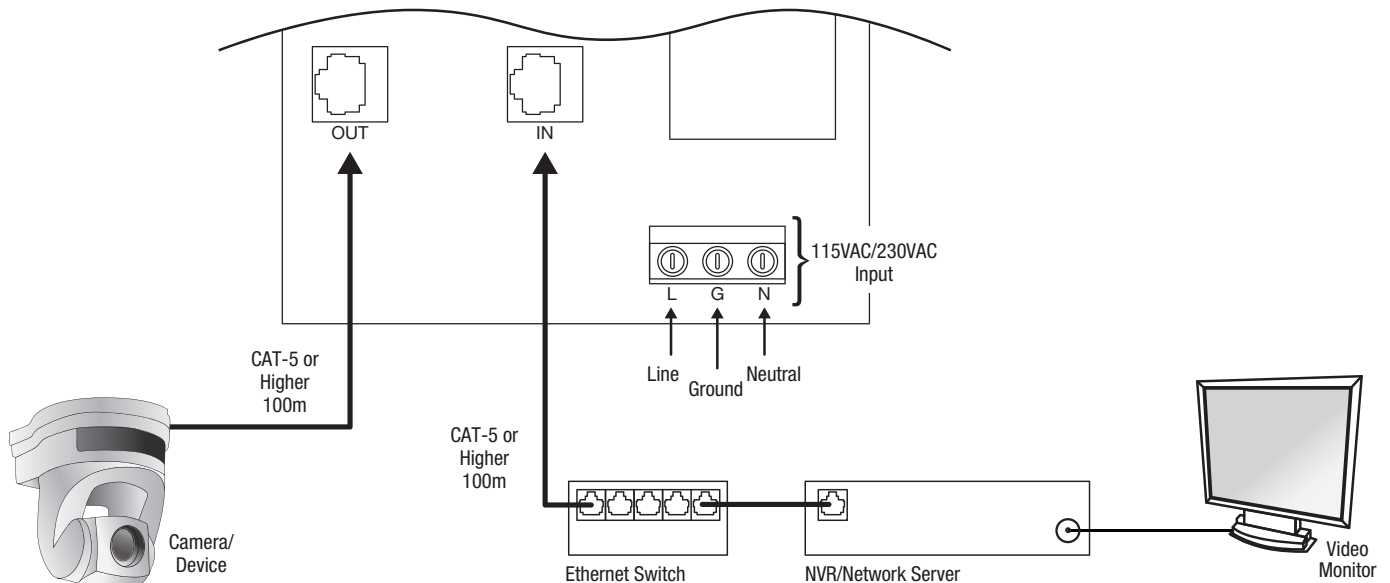

Lifetime Warranty

Specifications

Input

115VAC, 60Hz, 1.2A or 230VAC, 50/60Hz, 0.75A

Output

Maximum power: 60W
 Power provided using all 4 pairs on structured cable
 IEEE 802.3at (30W), IEEE 802.3af (15W) or 60W compliant
 Aux. Class 2 power-limited output rated @ 56VDC/60W
 Integral surge protection

Ethernet

Connectivity: RJ45, auto-crossover
 Wire type: 4-pair CAT5e or higher structured cable
 Distance: up to 100m
 Speed: 10/100/1000 BaseT, half/full duplex, auto negotiation

Indicators (LED)

LED 1: PoE active
 LED 2: AC Power present
 Yellow and Green LEDs (by RJ45 jack):
 IP Link status, 10/100Base-T/active

Agency Listings

UL/cUL	
UL60950-1	Information Technology Equipment
UL 60950-22	Information Technology Equipment to be installed Outdoors
CE	European Conformity

Physical and Environmental

Dimensions (W x L x H)

Enclosure:
 9.5" x 7.32" x 4.92" (241.3mm x 185.9mm x 125mm)
 Shipping:
 13" x 10" x 7" (330.2mm x 254mm x 177.8mm)

Weight (approx.)

Product:	3.7 lb. (1.68 kg)
Shipping:	5.0 lb. (2.27 kg)

Temperature

Operating:	
30W:	- 30°C to 70°C (- 22°F to 158°F)
60W:	- 30°C to 55°C (- 220°F to 131°F)
Storage:	- 40°C to 85°C (- 40° to 185°F)

Relative Humidity	85% +/- 5%
Operating Altitude:	- 304.8 to 2,000m

Accessories (order separately)

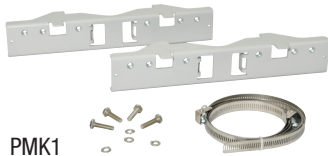

PMK1 - Pole Mount Kit

PMK1 pole mount kit is designed to simplify installation of outdoor units. It accommodates 2" - 8"(diameter) poles.

PMK1

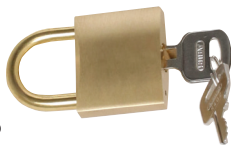

LOCK1WP - Pad Lock for Altronix Outdoor Enclosures

Altronix Lock1WP is a pad lock to secure the latches on Altronix outdoor enclosures. Includes a single pad lock and two (2) keys.

Lock1WP



WG1 - NEMA Rated Wire Gland Inlet

Altronix WG1 facilitates wiring for all Altronix outdoor enclosures.

WG1

Lifetime Warranty

Dimensions and Drawing

Enclosure Dimensions (H x W x D approximate)
 9.5" x 7.32" x 4.92" (241.3mm x 185.9mm x 125mm)

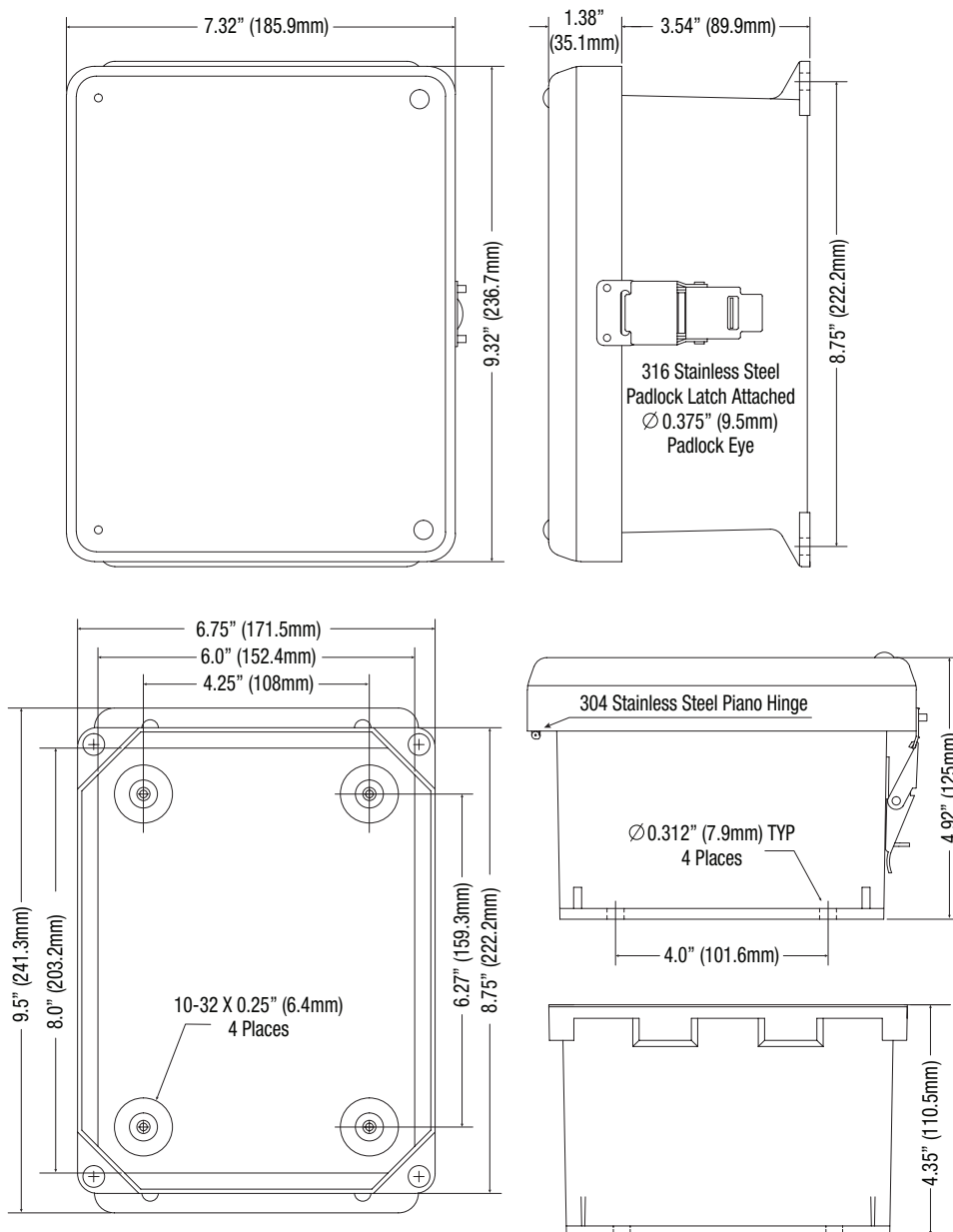

Lifetime Warranty